

# Lead-Lined Phantom and Storage Cabinet



## Description

The Lead-Lined Phantom and Storage Cabinet combines isotope storage drawers with a dedicated compartment for flood sources. The dedicated compartment supports organized storage and consistent placement of flood sources used in routine nuclear medicine operations. The unit is fully shielded and includes a stainless-steel countertop suitable for daily nuclear medicine workflows.

## Part of the Capintec Cabinet Portfolio

Capintec lead-lined cabinetry delivers a modular, engineered solution for radiopharmaceutical processing and hot-lab infrastructure. Fabricated for long-term durability and validated shielding performance, the portfolio supports controlled handling, secure storage, decay management, and preparation of radionuclides used in SPECT, PET, and emerging theranostic applications. The portfolio interfaces across isotope preparation zones, unit dose handling, radioactive waste pathways, and phantom logistics to standardize workflows, support ALARA guidelines, and optimize spatial efficiency while safeguarding personnel.

## Benefits

- Dedicated flood phantom compartment for items up to 13" w x 21" depth x 23" h (33.0 cm x 53.3 cm x 58.4 cm)
- Multiple removable isotope storage drawers
- Fully shielded construction for safety
- Key-locked drawers and cupboard for secure storage
- Stainless steel countertop includes a 4" (10.2 cm) backsplash and a 0.5" (1.3 cm) spill-proof lip
- Compatible with grouped cabinet configurations
- Lead shielding available in 0.25", 0.5" and 1" thickness on all six sides

## Lead Shielding Effectiveness

	0.25" (0.64 cm)	0.5" (1.3 cm)	1.0" (2.5 cm)
<b>140 KeV</b>	100%	100%	100%
<b>511 KeV</b>	67.6%	89.5%	98.9%

# Capintec | Lead-Lined Phantom and Storage Cabinet

## Specifications

**Dimensions:** 36.5" w x 24" depth x 36.0" h  
(92.7 x 61 x 91.4 cm)

**Lead Shielding:** 0.25" (0.64 cm), 0.5" (1.3 cm) or 1.0" (2.5 cm) thick on all six sides

**Pull Out Drawer Inner Dimensions:**  
6" w x 11.5" depth x 4.5" h (15.2 x 29.2 x 11.4 cm)

**Door and Drawers:** Key-locked

**Countertop:** Stainless steel with 4" (10.2 cm) backsplash and 0.5" (1.3 cm) spillproof lip

**Countertop Height:** 36.5" (92.7 cm)

**Finish:** Powder coat

**Countertop Configuration:** Supplied standard as an individual cabinet with stainless steel countertop. Cabinets may also be specified without a countertop when combined with other cabinets using a contiguous countertop. Contact your Capintec sales representative for information on ordering cabinets that do not include a countertop.

## Weight:

**244-210:** 1,103 lb (501 kg)

**244-211:** 1,421 lb (645 kg)

**244-212:** 2,500 lb (1,134 kg)

## Ordering Information

244-210	Cabinet, Phantom and Storage, 0.25" lead with Stainless Steel Countertop
244-211	Cabinet, Phantom and Storage, 0.5" lead with Stainless Steel Countertop
244-212	Cabinet, Phantom and Storage, 1.0" lead with Stainless Steel Countertop

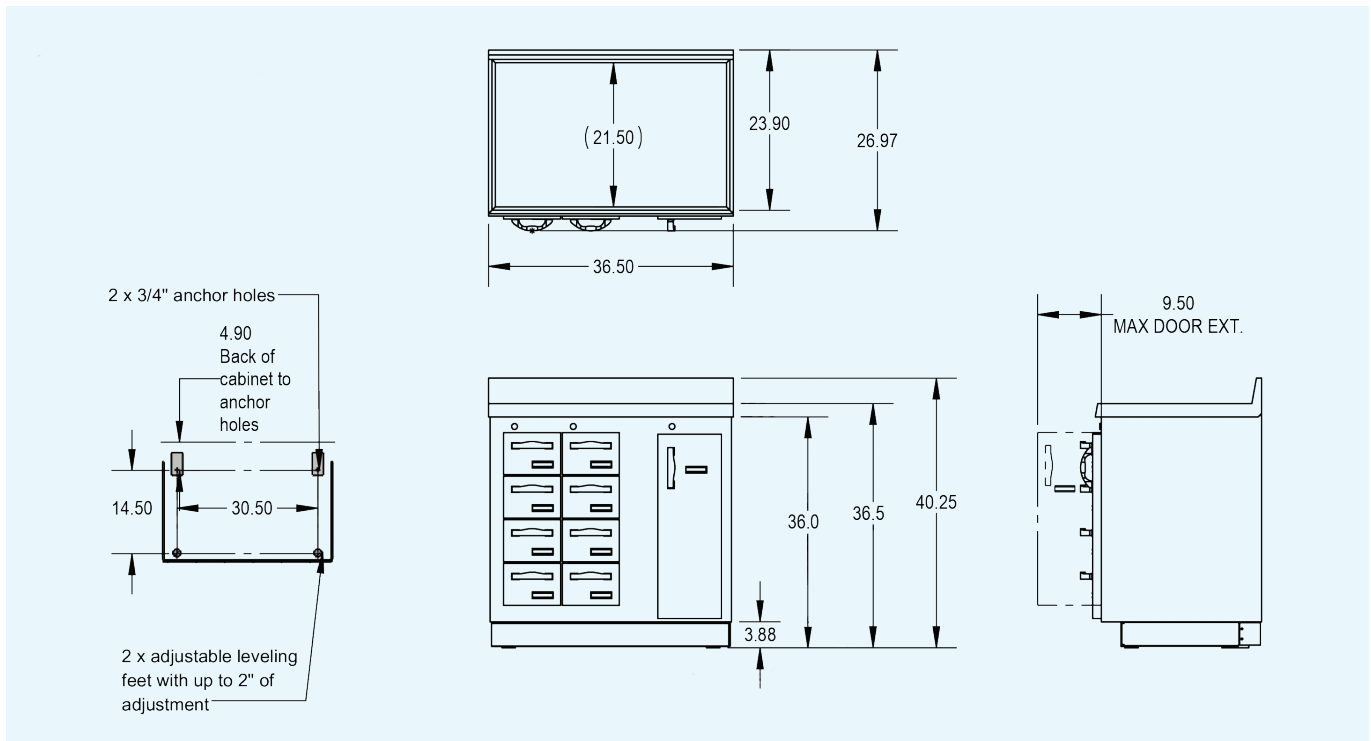

capintec.com

Mirion Technologies (Capintec), Inc. • 7 Vreeland Road, Florham Park, NJ 07932 USA

Copyright © 2026 Mirion Technologies, Inc. or its affiliates. All rights reserved. Mirion, the Mirion logo, and other trade names of Mirion products listed herein are registered trademarks or trademarks of Mirion Technologies, Inc. or its affiliates in the United States and other countries. Third party trademarks mentioned are the property of their respective owners.

SPC-697-A\_EN-CAP – 01/2026